

Mini installation beacon / LED Beacon 816 LED Perm. Beacon EM 24VDC MC



Part No.: 816.480.55



MECHANICAL DATA

| | |
|-----------------------------|---------------------------|
| Height | 97 mm |
| Diameter | 75 mm |
| Materials | PC |
| Dome colour | Clear |
| Protection category | IP65 |
| Connection | M12 plug 4-pole |
| Tension relief | Present (conforms to VDE) |
| Type of fixing | Built-in mounting |
| Working temperature minimum | -20°C |
| Working temperature maximum | +50°C |
| Weight with packaging | 132 g |
| Product weight | 110 g |

ELECTRICAL DATA

| | |
|-----------------------------|---------------------------|
| Operating voltage | 24V |
| Operating voltage type | DC |
| Operating voltage tolerance | +/- 10% |
| Rated operational voltage | 24 VDC |
| Rated operational current | 120 mA |
| Rated inrush current | 500 mA |
| Protection class | Protection class 2 |
| Pollution degree | 3 |
| | In the connection area: 2 |

OPTICAL DATA

| | |
|----------------------|------------------|
| Light source | LED |
| Light colour | MC 7 colours |
| Optical signal image | Permanent |
| Service life optical | 50,000 h maximum |

APPROVAL DATA

| | |
|------------------------------|---------|
| Conforms with CE | Yes |
| Conforms with RoHS directive | Yes |
| WEEE | Yes |
| Conforms with ATEX-directive | No |
| Conforms with CCC | No |
| Conforms with UL | cULus |
| UL Type Rating | Type 12 |
| Conforms with FCC | No |



For additional installation and mounting information, refer to the appropriate user guide at www.werma.com. This printed copy is for information only and is subject to alteration.

Mini installation beacon / LED Beacon 816

LED Perm. Beacon EM 24VDC MC

| | |
|-------------------------------|-----------------------|
| Conforms with IC | No |
| EAC certificate available | Yes |
| Conforms with UKCA (Importer) | Yes (WERMA (UK) Ltd.) |
| Conforms with AS-I | No |
| ICAO Certification | No |
| Conforms with DNV | No |
| Conforms with RoHS CN | No |
| Conforms with VdS | No |

DRAWING

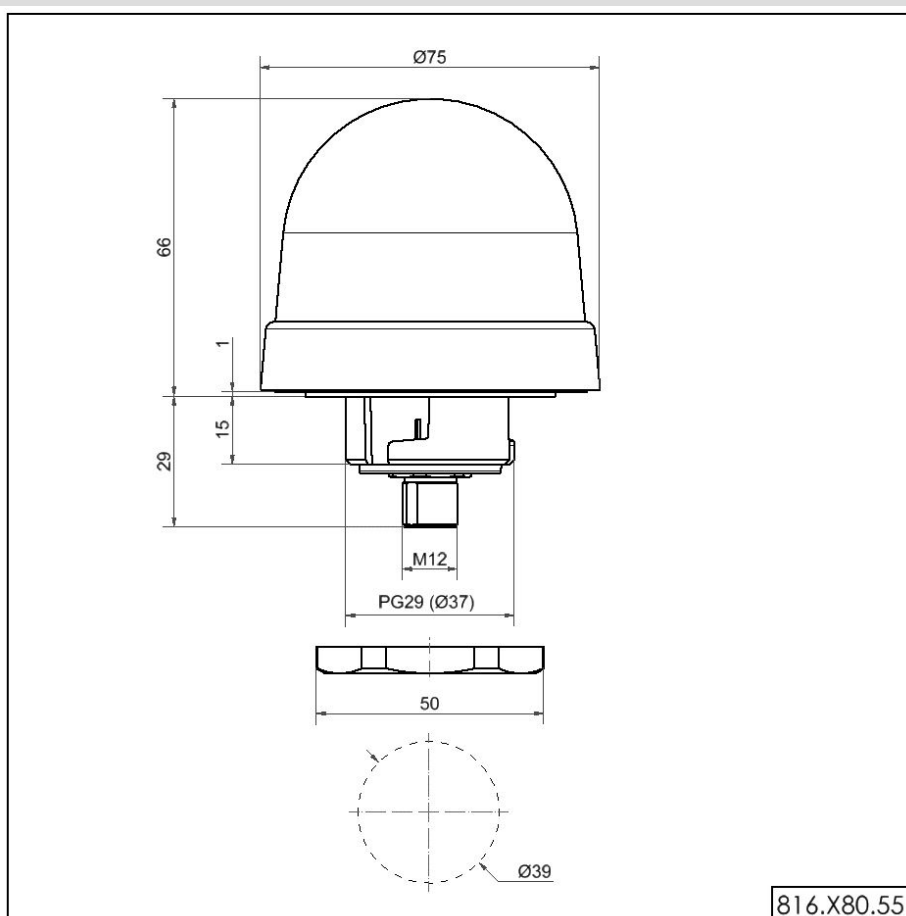

For additional installation and mounting information, refer to the appropriate user guide at www.werma.com. This printed copy is for information only and is subject to alteration.