

KombiSIGN 71 / WIN

WIN ethernet master 115-230VAC BK



Part No.: 860.000.06



MECHANICAL DATA

| | |
|-----------------------------|-------|
| Length | 80 mm |
| Width | 76 mm |
| Height | 30 mm |
| Materials | ABS |
| Housing colour | Black |
| Protection category | IP20 |
| Connection | USB |
| Working temperature minimum | 0°C |
| Working temperature maximum | +40°C |
| Weight with packaging | 506 g |
| Product weight | 441 g |

ELECTRICAL DATA

| | |
|-----------------------------|------------------------------|
| Operating voltage | 115-230V |
| Operating voltage type | AC |
| Operating voltage frequency | 50Hz at 230V 60Hz at 115V |
| Operating voltage tolerance | +/- 10% |
| Rated operational voltage | 230 VAC |
| Rated operational current | 160 mA |
| Rated inrush current | 800 mA |
| Protection class | Protection class 2 |
| Pollution degree | 2 |
| Overvoltage category | II |
| Isolation voltage | Ui = 250V; Uimp = 2.500V |
| connectivity | Ethernet WIN |

APPROVAL DATA

| | |
|-------------------------------|-----------------------|
| Conforms with CE | Yes |
| Conforms with RoHS directive | Yes |
| WEEE | Yes |
| Conforms with ATEX-directive | No |
| Conforms with CCC | No |
| Conforms with UL | No |
| Conforms with FCC | No |
| Conforms with IC | No |
| EAC certificate available | Yes |
| Conforms with UKCA (Importer) | Yes (WERMA (UK) Ltd.) |



For additional installation and mounting information, refer to the appropriate user guide at www.werma.com. This printed copy is for information only and is subject to alteration.

KombiSIGN 71 / WIN

WIN ethernet master 115-230VAC BK

| | |
|-----------------------|----|
| Conforms with AS-I | No |
| ICAO Certification | No |
| Conforms with DNV | No |
| Conforms with RoHS CN | No |
| Conforms with VdS | No |

DRAWING

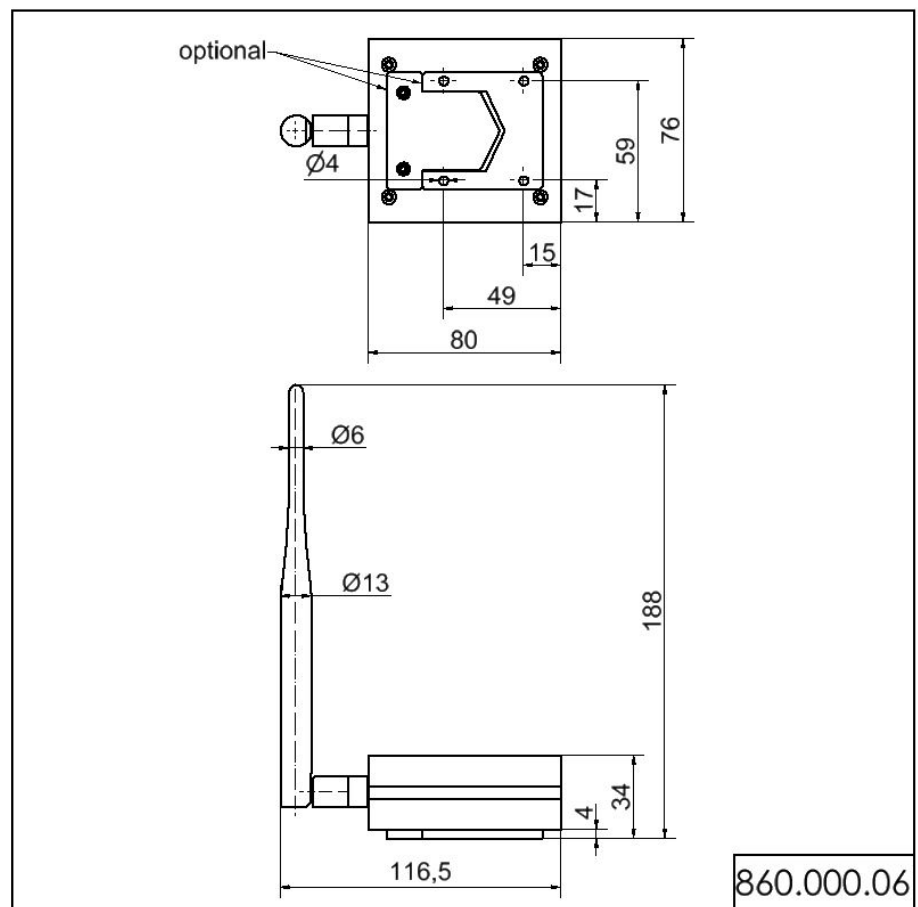

 For additional installation and mounting information, refer to the appropriate user guide at www.werma.com. This printed copy is for information only and is subject to alteration.