

KombiSIGN 71 / WIN

WIN ethernet receiver 115-230VAC BK

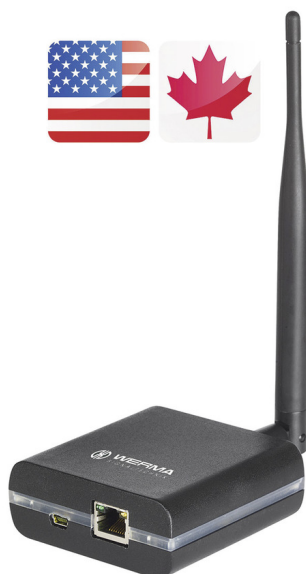

Part No.: 860.000.07



MECHANICAL DATA

Length	80 mm
Width	76 mm
Height	30 mm
Materials	ABS
Housing colour	Black
Protection category	IP20
Connection	USB
Working temperature minimum	0°C
Working temperature maximum	+40°C
Weight with packaging	494 g
Product weight	436 g

ELECTRICAL DATA

Operating voltage	115-230V
Operating voltage type	AC
Operating voltage frequency	50Hz at 230V 60Hz at 115V
Operating voltage tolerance	+/- 10%
Rated operational voltage	230 VAC
Rated operational current	160 mA
Rated inrush current	800 mA
Protection class	Protection class 2
Pollution degree	2
Overvoltage category	II
Isolation voltage	Ui = 250V; Uimp = 2.500V
connectivity	Ethernet WIN

APPROVAL DATA

Conforms with CE	No
Conforms with RoHS directive	Fulfills substance restriction
WEEE	Yes
Conforms with ATEX-directive	No
Conforms with CCC	No
Conforms with UL	No
Conforms with FCC	Yes
Conforms with IC	Yes
EAC certificate available	Yes
Conforms with AS-I	No



For additional installation and mounting information, refer to the appropriate user guide at www.werma.com. This printed copy is for information only and is subject to alteration.

KombiSIGN 71 / WIN

WIN ethernet receiver 115-230VAC BK

ICAO Certification	No
Conforms with DNV	No
Conforms with RoHS CN	No
Conforms with VdS	No

DRAWING

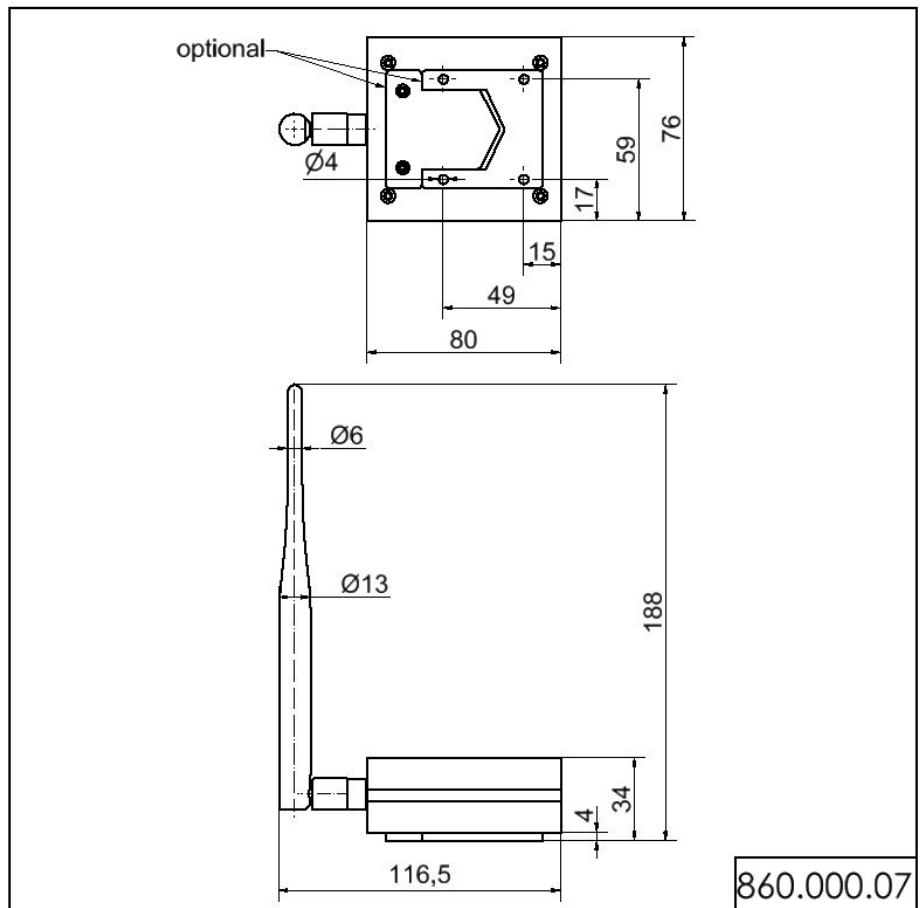

For additional installation and mounting information, refer to the appropriate user guide at www.werma.com. This printed copy is for information only and is subject to alteration.